

## STYLE ONE

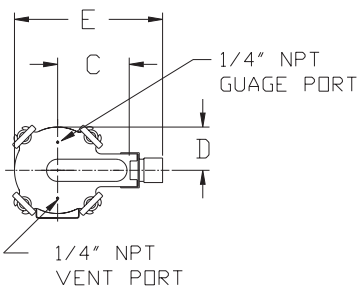

FITTING  
SIZE

	A	B	C	D	E
1 FNPT	12-1/2	6-3/4	7-3/8	2-7/8	10-3/16

STD.

1-1/2 FNPT	12-1/2	6-3/4	7-3/8	2-7/8	10-3/16
------------	--------	-------	-------	-------	---------

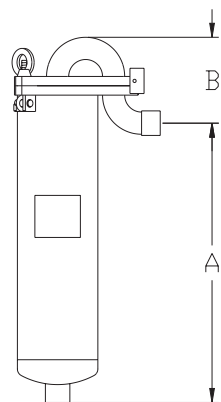

## STYLE TWO

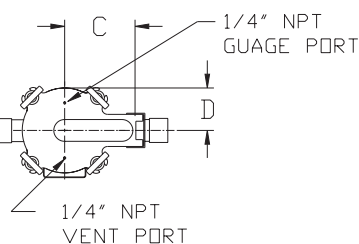

O  
P  
T  
I  
O  
N  
S

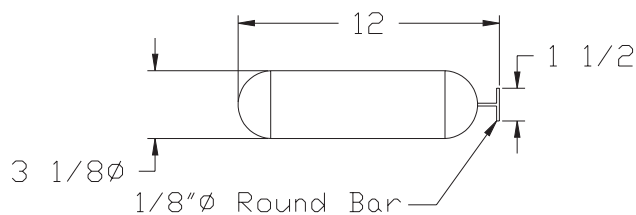

DISPLACEMENT BALLOON

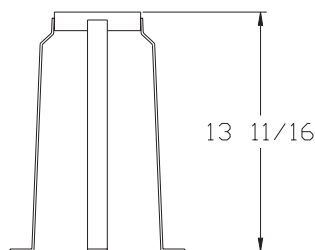
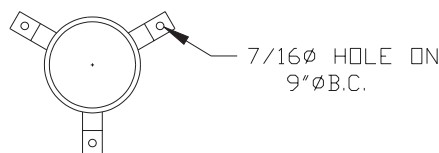

STAND

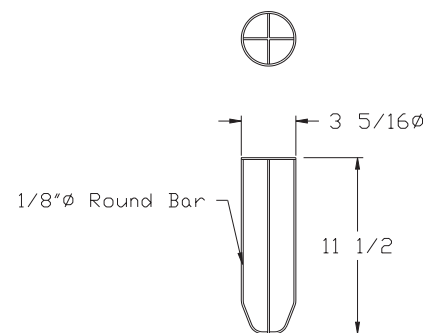

BACKFLUSH RESTRAINER

FITTING  
SIZE

	A	B	C	D	E
1" FNPT	12-1/2	6-3/4	7-3/8	2-7/8	11-3/4

STD.

1-1/2" FNPT.	12-1/2	6-3/4	7-3/8	2-7/8	11-3/4
--------------	--------	-------	-------	-------	--------

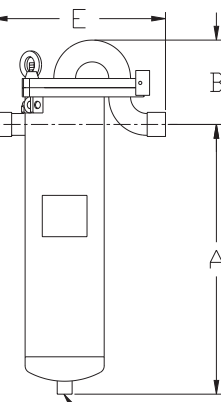

1/2" NPT DRAIN

SHIPPING WEIGHT  
VOLUME  
DESIGN PRESSURE

21 lbs.  
1 US. gal.  
150 psig. @ 225 °F